

CONFIGURATION TABLE ③

MODEL NO.	'X' (mm)	'Y' (mm)	'Z' (mm)	MASS (g)
LDX-095-013	14.5	14.5	29.5	679±50
LDX-095-025	27	27	42	1110±50
LDX-095-038	39.5	39.5	54.5	1541±50
LDX-095-050	52	52	67	1973±50
LDX-095-075	77	77	92	2828±75

REVISIONS			DRW	CHK	DRE
REV	DATE	DESCRIPTION	GAR	DDR	PK
A	2023-04-13	INITIAL RELEASE			

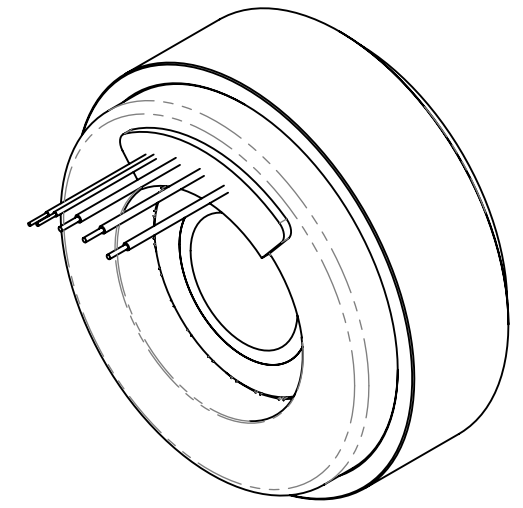
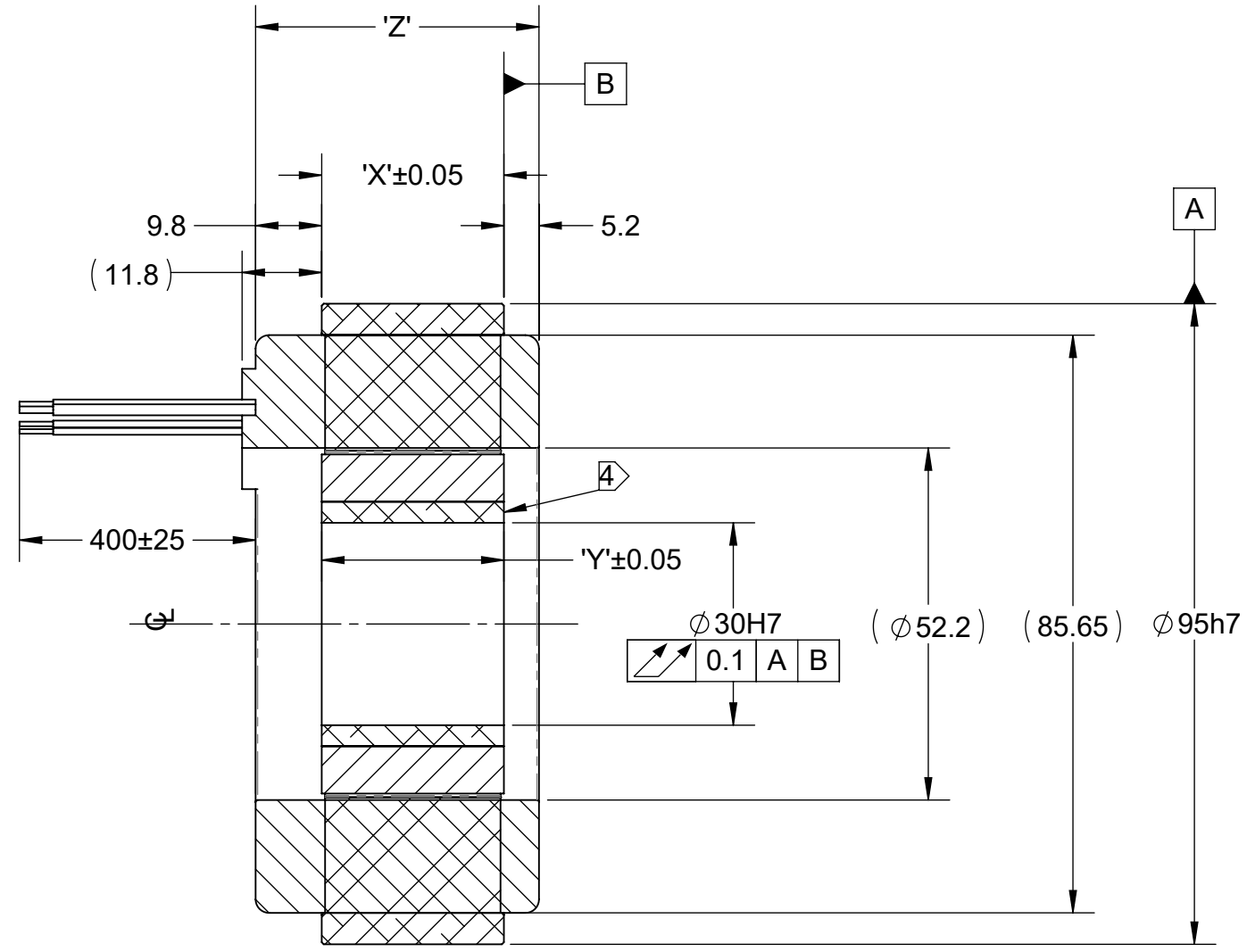
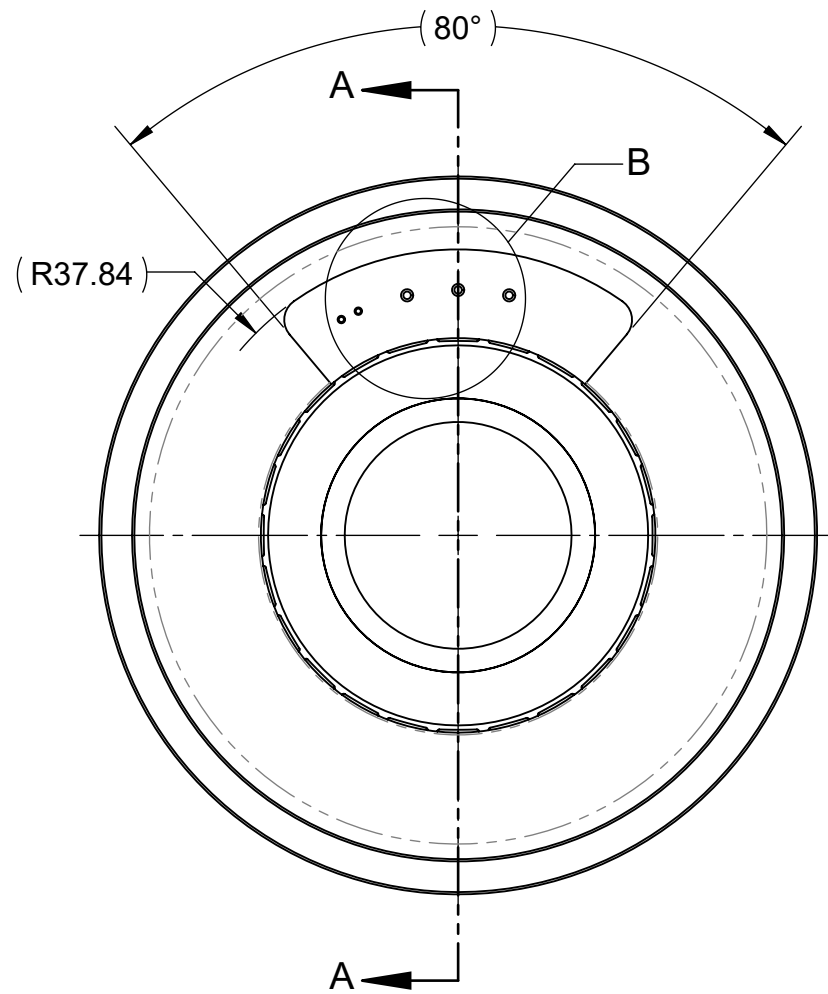

PICTORIAL VIEW

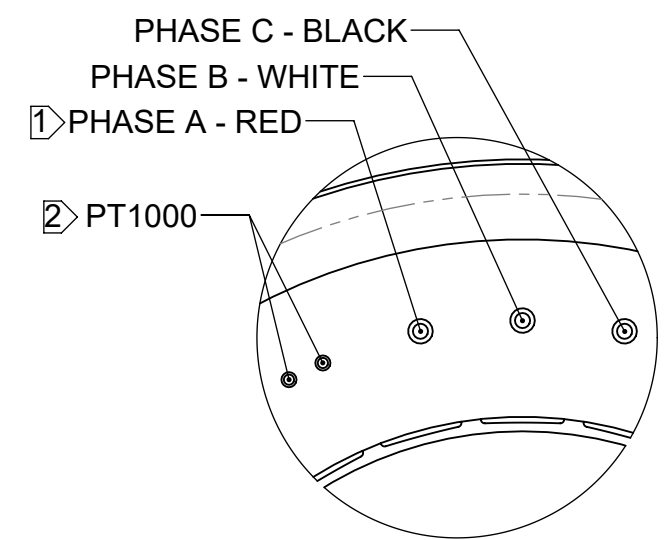

DETAIL B  
SCALE 2 : 1

- NOTES:**
- ① ALL MOTOR WIRES ARE 14 AWG.
  - ② PT1000 WIRES ARE 24 AWG.
  - ③ DEPENDANT ON MODEL NUMBER. SEE CONFIGURATION TABLE. LDX-095-025 SHOWN.
  - ④ ROTOR SURFACE TO BE COPLANAR WITH DATUM B

<p><b>PROPRIETARY AND CONFIDENTIAL</b></p> <p>THE INFORMATION CONTAINED IN THIS DRAWING IS THE SOLE PROPERTY OF GENESIS MOTION SOLUTIONS, LP. ANY REPRODUCTION IN PART OR AS A WHOLE WITHOUT THE WRITTEN PERMISSION OF GENESIS MOTION SOLUTIONS IS PROHIBITED. COPYRIGHT GENESIS MOTION SOLUTIONS, LP. ALL RIGHTS RESERVED.</p>	<p>MATERIAL <b>NONE</b></p>			
	<p>FINISH <b>NONE</b></p>			
	<p>INTERPRET GEOMETRIC TOLERANCES AS PER ASME Y14.5-2009</p>	<p>UNLESS OTHERWISE SPECIFIED</p> <p>1. DIMENSION UNITS: mm</p> <p>2. TOLERANCES: SURFACE FINISH 3.2/</p> <p>ANGULAR: ±2°</p> <p>LINEAR: ±0.2</p>	<p>MASS ③</p>	<p>TITLE MOTOR INTERFACE, LDX 095-XXX</p>
	<p>3. REMOVE BURRS &amp; BREAK SHARP EDGES 0.3 MAX</p> <p>4. INTERNAL CORNERS MODELED AS SHARP TO BE R0.2 MAX</p>	<p>INITIAL DRE SCALE</p> <p>PK 1:1</p>	<p>PART NO</p> <p>CONFIGURABLE</p>	<p>SIZE DWG NO</p> <p>B 107670</p>