

CONFIGURATION TABLE 3

MODEL NO.	'X' (mm)	'Y' (mm)	'Z' (mm)	MASS (g)
LDX-095-013	14.5	14.5	29.5	679±50
LDX-095-025	27	27	42	1110±50
LDX-095-038	39.5	39.5	54.5	1541±50
LDX-095-050	52	52	67	1973±50
LDX-095-075	77	77	92	2828±75

REVISIONS			DRW	CHK	DRE
REV	DATE	DESCRIPTION	GAR	DDR	PK
A	2023-04-13	INITIAL RELEASE			
B	2023-10-03	UPDATING MIN AND MAX DIMENSIONS OF STATOR ID AND POTTING OD	AI	DDR	AI

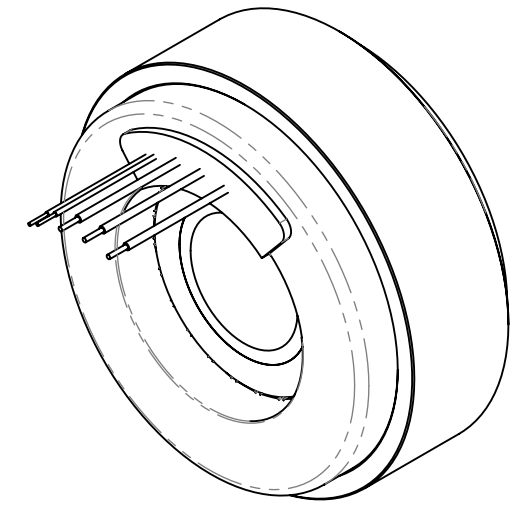
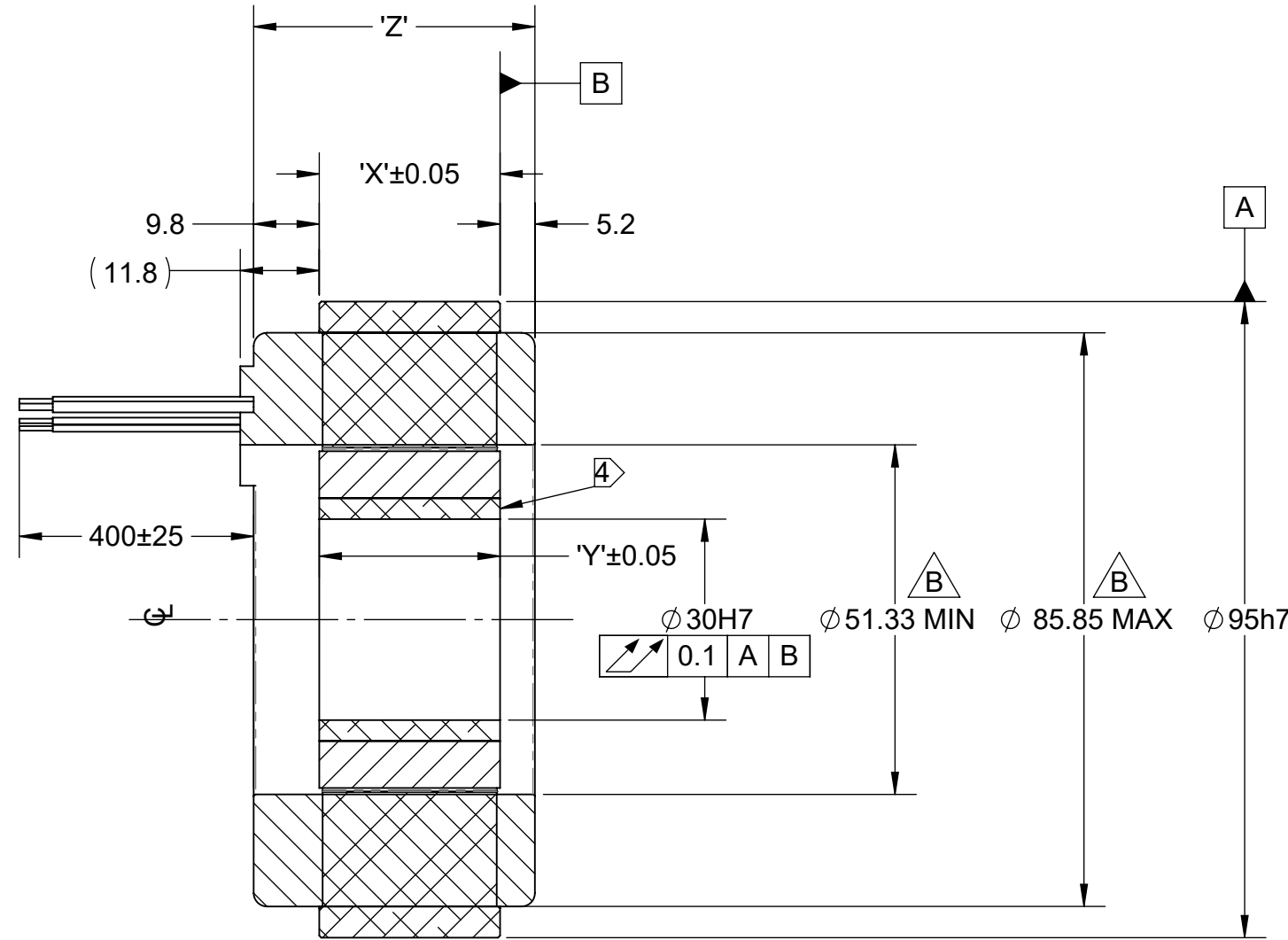
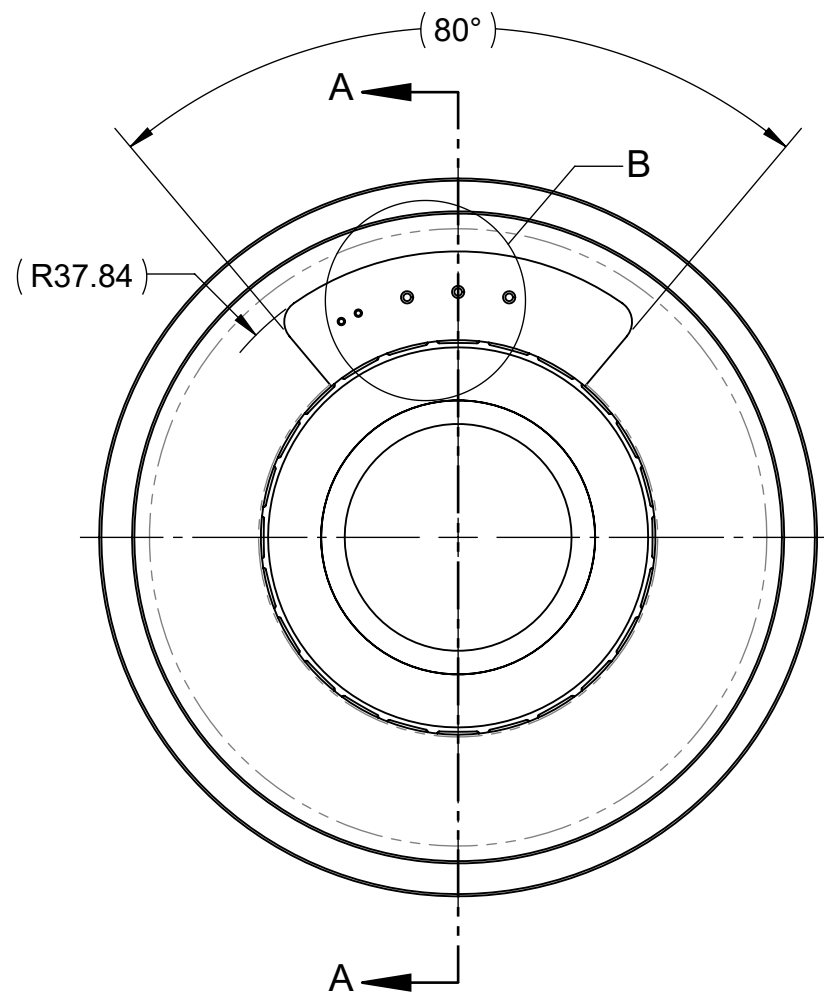

PICTORIAL VIEW

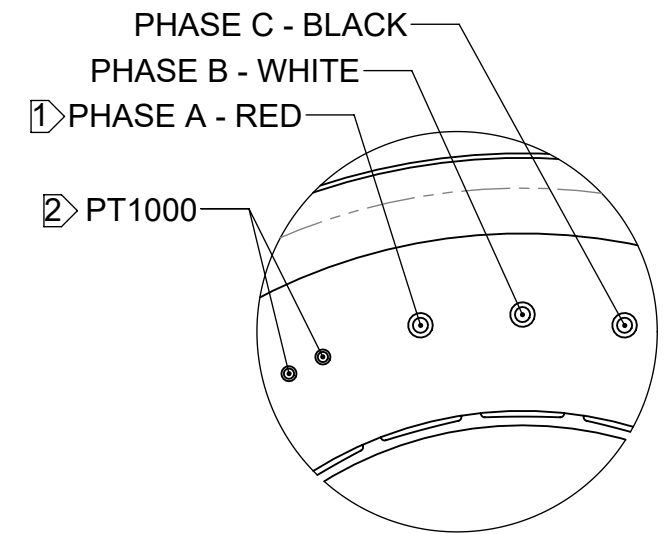

DETAIL B
SCALE 2 : 1

NOTES:

- 1 ALL MOTOR WIRES ARE 14 AWG.
- 2 PT1000 WIRES ARE 24 AWG.
- 3 DEPENDANT ON MODEL NUMBER. SEE CONFIGURATION TABLE. LDX-095-025 SHOWN.
- 4 ROTOR SURFACE TO BE COPLANAR WITH DATUM B

<p>PROPRIETARY AND CONFIDENTIAL</p> <p>THE INFORMATION CONTAINED IN THIS DRAWING IS THE SOLE PROPERTY OF GENESIS MOTION SOLUTIONS, LP. ANY REPRODUCTION IN PART OR AS A WHOLE WITHOUT THE WRITTEN PERMISSION OF GENESIS MOTION SOLUTIONS IS PROHIBITED. COPYRIGHT GENESIS MOTION SOLUTIONS, LP. ALL RIGHTS RESERVED.</p>	<p>MATERIAL NONE</p>			
	<p>FINISH NONE</p>			
	<p>INTERPRET GEOMETRIC TOLERANCES AS PER ASME Y14.5-2009</p>	<p>UNLESS OTHERWISE SPECIFIED</p> <p>1. DIMENSION UNITS: mm</p> <p>2. TOLERANCES: SURFACE FINISH: 3.2/</p> <p>ANGULAR: ±2°</p> <p>LINEAR: ±0.2</p> <p>3. REMOVE BURRS & BREAK SHARP EDGES 0.3 MAX</p> <p>4. INTERNAL CORNERS MODELED AS SHARP TO BE R0.2 MAX</p>	<p>MASS 3</p>	<p>TITLE MOTOR INTERFACE, LDX 095-XXX</p>
	<p>3. REMOVE BURRS & BREAK SHARP EDGES 0.3 MAX</p> <p>4. INTERNAL CORNERS MODELED AS SHARP TO BE R0.2 MAX</p>	<p>INITIAL DRE PK</p> <p>SCALE 1:1</p>	<p>PART NO CONFIGURABLE</p> <p>SIZE B</p> <p>DWG NO 107670</p>	<p>REV B</p> <p>SHEET 1 of 1</p>